

# MIRACO 3D SCANNER

Quick Start Guide V1.1

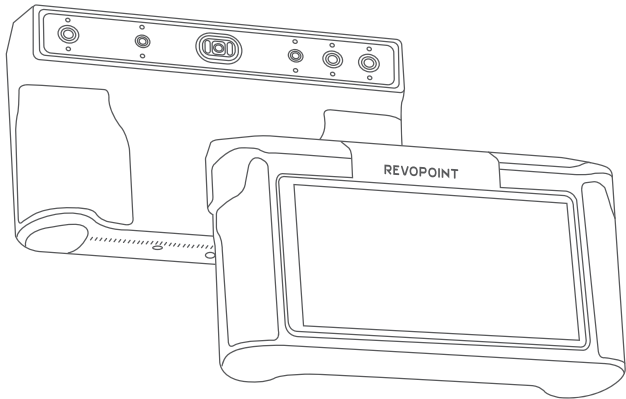

**REVOPOINT**



If MIRACO's software functions are updated, the *Quick Start Guide* will be updated to reflect the changes. Please scan the QR code and visit the official support page to download the latest version.

[www.revopoint3d.com/pages/  
support-miraco](http://www.revopoint3d.com/pages/support-miraco)

# Contents

<b>About MIRACO</b>	01
<b>What's in the Box?</b>	02
<b>First Use</b>	03
Unboxing and Setup	03
Helpful Screen Gestures	05
Scan	06
Model Edit	08
<b>Software Update</b>	09
<b>Skills</b>	10
Using Single Shot Mode	10
Using Marker Mode	11
File Transfers Via USB Cable	12
Connecting to an External Screen	13

## About MIRACO

MIRACO is a versatile, all-in-one 3D scanner designed for professionals. Featuring a robust quad-depth camera system, it offers accuracy ranging from ultra-fine detail capture with a single-frame accuracy up to 0.05 mm to broader area scans with still remarkable accuracy. Its high-resolution RGB camera also ensures stunningly realistic color scans, making it a powerful tool for a wide range of 3D scanning applications.

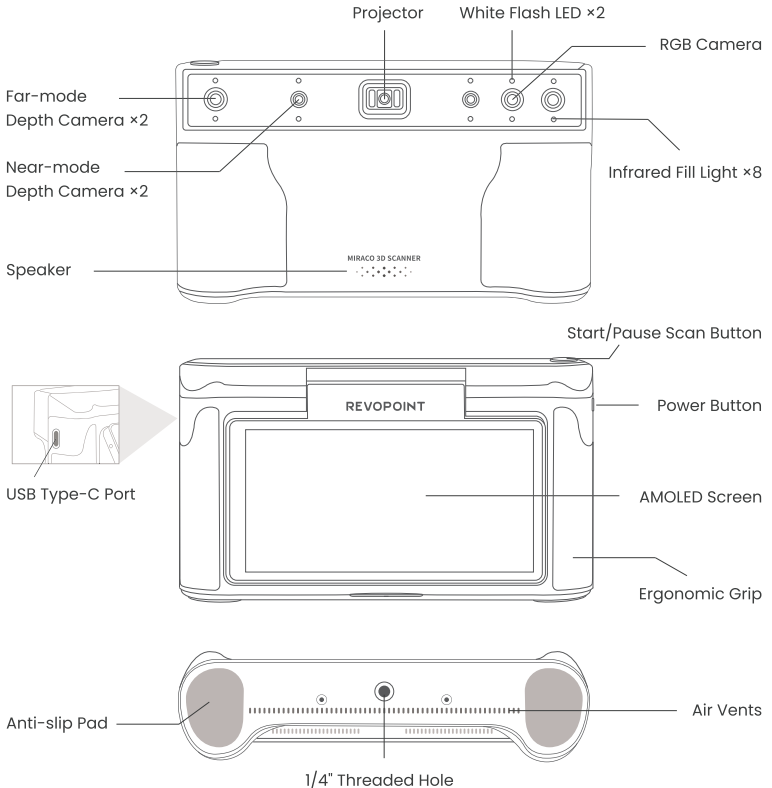

## What's in the Box?

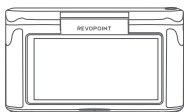

MIRACO 3D Scanner

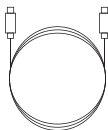

USB Type-C to C Cable  
(1.8 m)

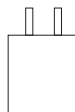

65W Dual USB Type-C Port  
Power Adapter

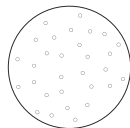

Turntable Topper

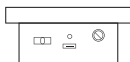

Mini Turntable



Turntable USB Cable



MIRACO Near-mode  
Calibration Board

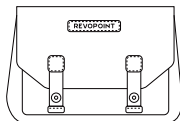

Scanner Bag

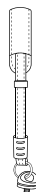

Wrist Strap



Tripod

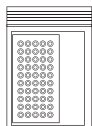

Markers, Magic Mat x2  
Cleaning Cloth x1



Sample Bust



Quick Start Guide  
Certificate & Warranty Card

### Note:

1. The MIRACO Pro (32 GB RAM) package also includes the Far-mode Calibration Board x4, Large Calibration-board Sheet x1 and a USB Type-C to HDMI Adapter.
2. The Power Adapter may vary depending on the country or region.

# First Use

## Unboxing and Setup

**Step 1:** For the first use, please charge the MIRACO to more than 60%.

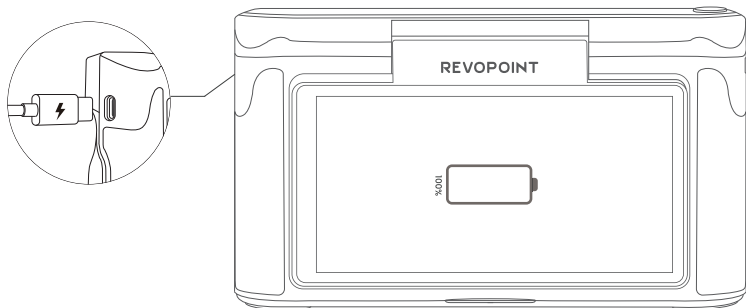

Note: If you do not use MIRACO for a long time, please charge it regularly to avoid permanent damage to the battery.

**Step 2:** Long-press the **Power Button** (5s) to turn on.

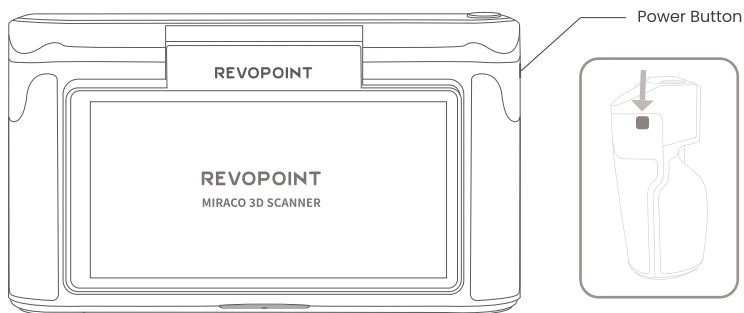

**Step 3: Select a language.**

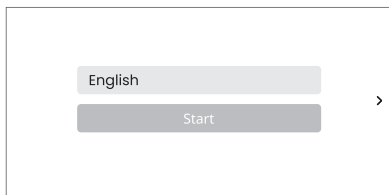

**Step 4: Connect to a Wi-Fi network** for project transfers and software update notifications.

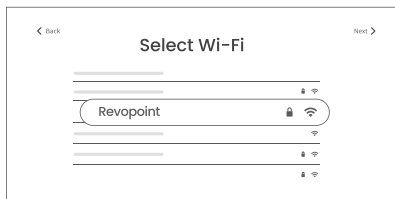

**Step 5: Adjust and confirm the Date and Time.**

**Step 6: Tap Next** to enter the **Scan Interface**. The elements in this interface are displayed below.

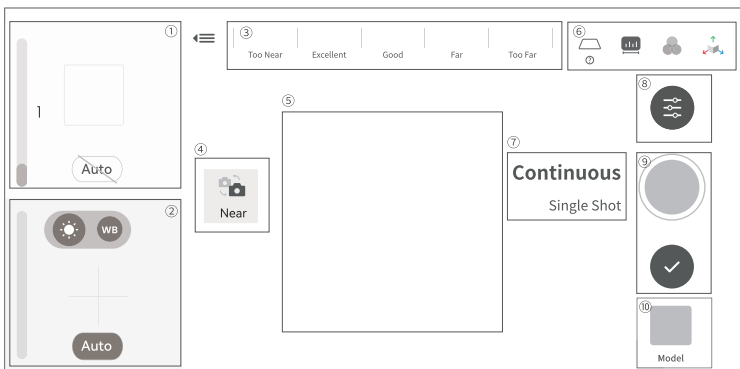

- ① Depth Display Window
- ② RGB Display Window
- ③ Distance Display
- ④ Far & Near Mode Switching
- ⑤ 3D Display Window
- ⑥ Base Removal / Scanning Distance / Color Display / 3D Coordinates
- ⑦ Continuous & Single-shot Switch
- ⑧ Scan Settings
- ⑨ Scan Control Buttons
- ⑩ Model Hub

## Helpful Screen Gestures

1. Swipe down from the top of the screen to display the Quick Settings menu.

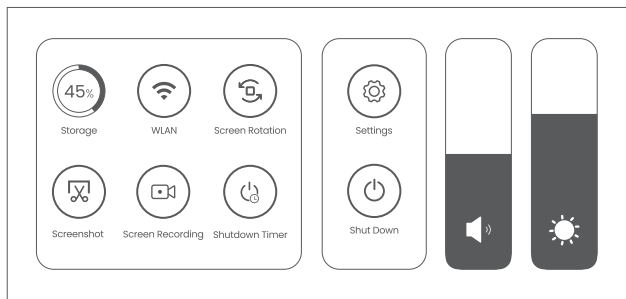

2. Screen Gestures for the Home or Post-processing page are as below:



### One-finger Swipe:

Rotates the model on the screen.



### Two-finger Drag:

Moves the model.



### Pinch to Zoom:

Together to zoom out; apart to zoom in.



### One-finger Drag:

Model selection.



# Scan

## Step 1: Instructions.

Read the instructions for [Scan Settings] and [Exposure Adjustment] on MIRACO when it is first activated.

## Step 2: Set up a scanning environment.

For the first scan, it is recommended to scan the **Sample Bust** included in the package. Find a tabletop free of any clutter, put the Sample Bust on the turntable, and ensure no unwanted objects are within the scanning area.

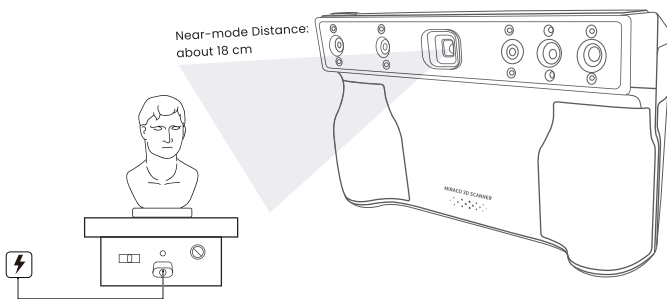

## Step 3: Select a scanning mode.

Selecting [Continuous] and [Near] modes to scan the Sample Bust is recommended.

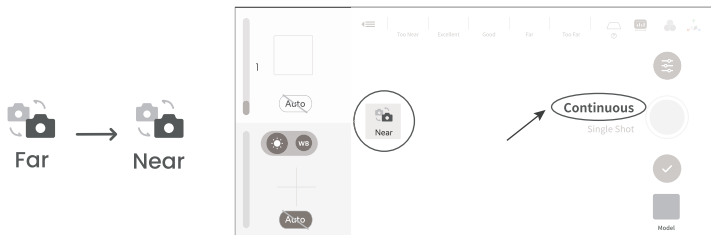

#### Step 4: Scan settings before scanning.

##### 1) Scan Settings

The recommended scan settings for Sample Bust are [High Accuracy], [Feature], [General], and [Color] toggled off.

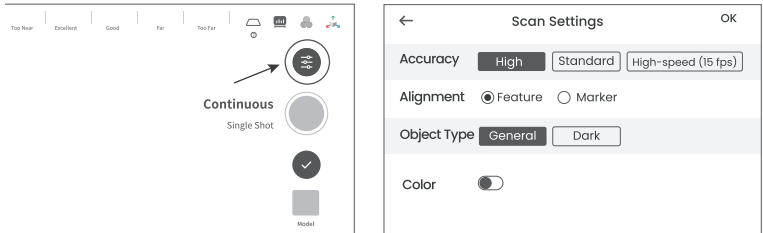

2) It's also recommended to turn [Base Removal Off].

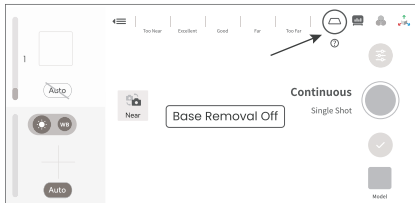

##### 3) Depth Cameras' exposure Adjustment

It is recommended to disable [Auto] exposure for the Depth Cameras and manually adjust the exposure bar until there are minimal red or blue areas in the preview.

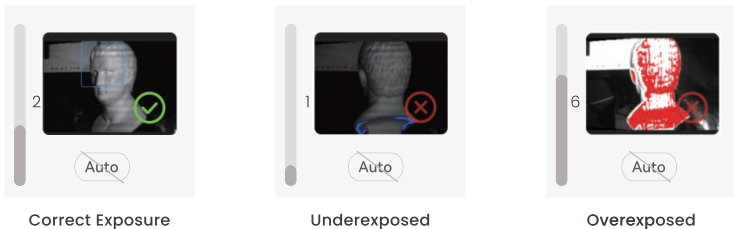

#### 4) Scan **Distance** Adjustment

Move MIRACO to adjust the **distance between the scanner and the target object**, ensuring the scanning distance indicator bar displays **green**.

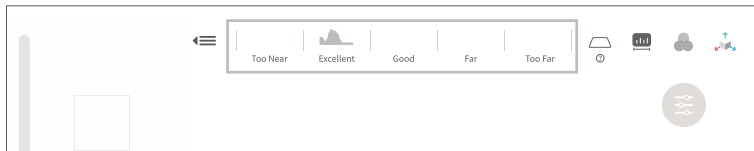

**Step 5: Start** scanning.

Tap the  button to **Start**, and tap it again  to pause your scan as needed.

**Step 6: Complete** scanning.

Tap the [Complete] button  to finish the scan when all data is captured.



## Model Edit

**Step 1:** After completing the scan, tap the [Model] icon to edit it.

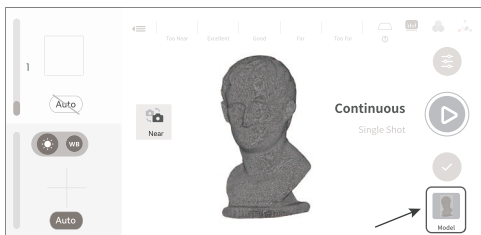

## Step 2: One-tap Edit and Manual Edit

### 1) One-tap Edit

Tap the [One-tap Edit] button to automatically perform point cloud Fusion, Mesh, and Texture (when Color mode is enabled).

It's recommended to select **One-tap Edit** for 3D scanning beginners.

### 2) Manual Edit

Tap the [Fusion], [Mesh], [Texture] in sequence to adjust the corresponding parameters and process the scan.

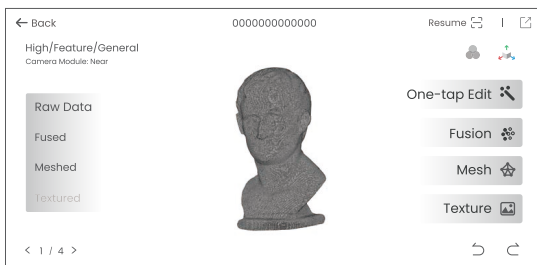

Refer to Revopoint Official Website (<https://www.revopoint3d.com/pages/support-miraco>) for MIRACO's *User Manual* for detailed parameter adjustment.

## Software Update

**Step 1:** Swipe down from the top of the screen, tap [Settings] > [WLAN], and connect to a network.



**Step 2:** Tap [Software Update] to check if a new version is available. If yes, tap [Download and Install] to update it.

**Step 3:** The update will install automatically. After the update, MIRACO will restart.

**Procedure:**

[Settings] > [WLAN] > Connect to a network > [Software Update] > [Download and Install] > MIRACO restarts

## Skills

### Using Single Shot Mode

**Step 1:** Tap [Single Shot] to switch to it.

**Step 2:** Adjust exposure and other scan parameters.

**Step 3:** Tap the capture button to record a single frame.

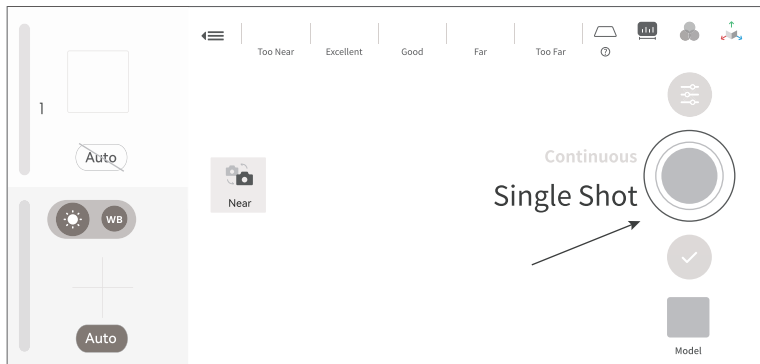

Scan the QR code for a Single-shot Video.

## Using Marker Mode

Scanning objects with simple geometric features, like a football or wine bottle, requires using Magic Mat, markers, or reference objects and scanning in Marker Alignment.

Adjust Scan Settings on MIRACO as below:

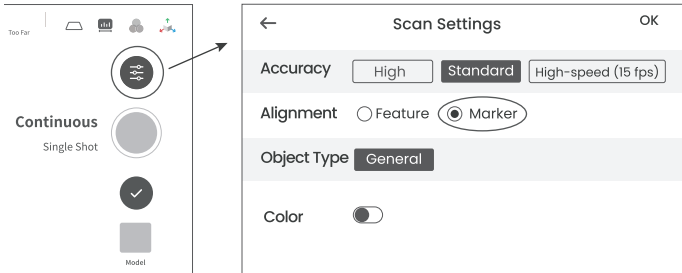

1. Place the Markers (or Magic Mat under the object) on or around the objects' surface irregularly and ensure there are at least 5 Markers per frame for the entire scan, or the scanner will lose track.

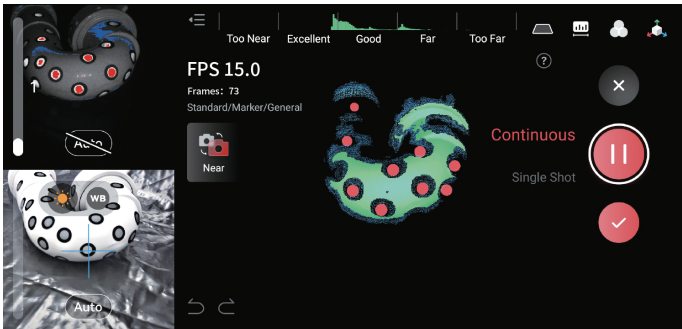

## File Transfers Via USB Cable

**Step 1:** Connect your MIRACO to a computer using the USB Type-C Cable.

**Step 2:** See the popup on MIRACO's screen and tap [Data Transfer].

**Step 3:** Find files on your computer.

1) Export Projects (Both Windows and macOS PCs are supported)

Open Revo Scan 5 on your PC, and make sure it's V 5.4.1 or after.

Check the target Projects and click Export on your PC.

**Project:** An album including the scanning configuration, Raw data, processed data, and user operation history in memory or hard disk. Each project can include one or more 3D models.

2) Find Screen Recording and File Transfers (ONLY works on Windows PCs)

**Windows:** Right-click the Windows icon on the toolbar, then click File Explorer. Expand This PC, and locate your hard drive. Then, find the MIRACO. Copy MIRACO's data to your PC.

**Path:** Windows icon → File Explorer → This PC → MIRACO → Internal shared storage → Copy MIRACO's data

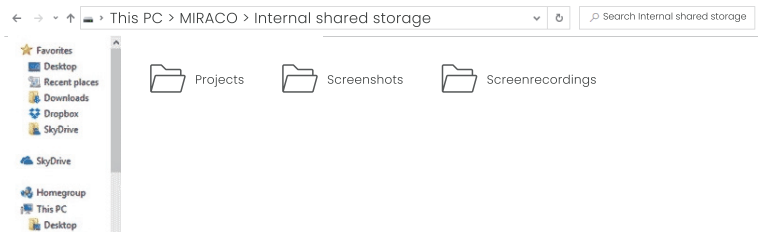

## Connecting to an External Screen

MIRACO supports the DisplayPort (DP) interface by using the USB Type-C port.

**Method 1:** A monitor or TV can be connected to MIRACO's DisplayPort (DP) via its USB Type-C port.

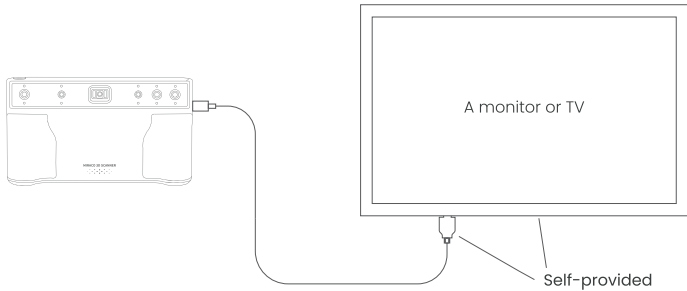

**Method 2:** Use the DP to HDMI Adapter (included with MIRACO Pro) to connect MIRACO to an HDMI cable on a TV or monitor.

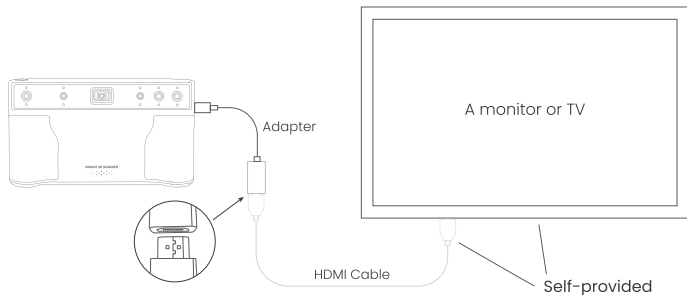



## IC Warning

This device complies with Industry Canada's licence-exempt RSS standard(s). Operation is subject to the following two conditions:

- (1) this device may not cause interference, and
- (2) this device must accept any interference, including interference that may cause undesired operation of the device.

This Class B digital apparatus complies with Canadian ICES-003.

IC RF Statement:

When using the product, maintain a distance of 20cm from the body to ensure compliance with RF exposure requirements.

## FCC Warning

This device complies with part 15 of the FCC Rules. Operation is subject to the following two conditions:

- (1) This device may not cause harmful interference, and
- (2) this device must accept any interference received, including interference that may cause undesired operation.

Any Changes or modifications not expressly approved by the party responsible for compliance could void the user's authority to operate the equipment.

**Note:** This equipment has been tested and found to comply with the limits for a Class B digital device, pursuant to part 15 of the FCC Rules. These limits are designed to provide reasonable protection against harmful interference in a residential installation. This equipment generates uses and can radiate radio frequency energy and, if not installed and used in accordance with the instructions, may cause harmful interference to radio communications. However, there is no guarantee that interference will not occur in a particular installation. If this equipment does cause harmful interference to radio or television reception, which can be determined by turning the equipment off and on, the user is encouraged to try to correct the interference by one or more of the following measures:

- Reorient or relocate the receiving antenna.
- Increase the separation between the equipment and receiver.
- Connect the equipment into an outlet on a circuit different from that to which the receiver is connected.
- Consult the dealer or an experienced radio/TV technician for help.

This equipment complies with FCC radiation exposure limits set forth for an uncontrolled environment.

This equipment should be installed and operated with minimum distance 20cm between the radiator & your body.

# Online Support

WE ARE HERE FOR YOU



Scan the QR code left with your phone and contact us for help.

Contact Us

---

## Follow Us



This content is subject to change.

COPYRIGHT © 2023 REVOPPOINT 3D ALL RIGHTS RESERVED.